

**Proposal for Mayor's Beautification Initiative
110 Coleridge Avenue – Native Plant/Flower Garden**

The homeowners at 110 Coleridge Avenue propose to plant a native plant/flower garden in the enlarged right-of-way area located at the intersection of Coleridge Avenue and Wordsworth Avenue. This area is directly in front of their residence. Plants that are proposed for the area include Bee Balm, Black-eyed Susan, Butterfly Weed, Purple Echinacea, Joe Pye Weed, Yarrow, Lavender, and Catmint. These plants were chosen to attract butterflies and are arranged with the tallest in the back and shortest in the front in order to maintain sight distance at the intersection. The plantings will stay 8' off of Coleridge Avenue. An inspirational rock garden with painted and unpainted rocks in a removeable frame is proposed with people encouraged to take one or add one. Other proposed amenities include educational signage, free seed swap, trash can, bench, rain gauge, and bee water station. A paver path is proposed to split the garden. If approved the owner proposes to move forward with the work in the Spring of 2027. The owners have agreed to provide all maintenance of the site.

Public comment for this proposal will be received until June 15, 2026.

Mayor's Beautification Initiative
Muri - 110 Coleridge Ave

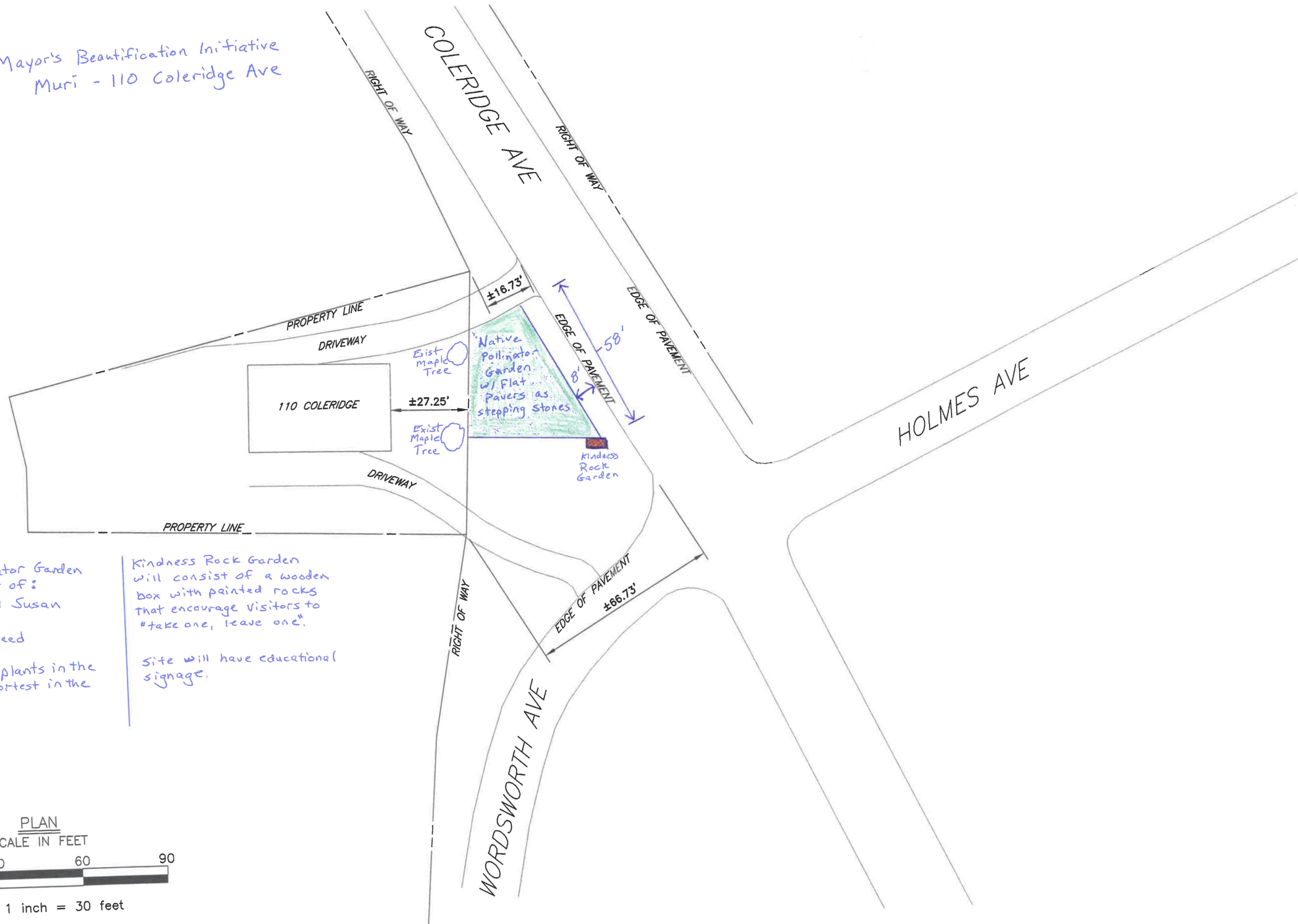

Native Pollinator Garden will consist of:

- Black Eyed Susan
- Yarrow
- Joe Pye Weed
- Bee Balm

with tallest plants in the back and shortest in the front.

Kindness Rock Garden will consist of a wooden box with painted rocks that encourage visitors to "take one, leave one".

site will have educational signage.

